



Travelling and towing in safety and comfort. BPW ZAF-2 towing hitch for cars, light truck trailers and caravans.

The decisive
lead

ZAF - 2



Properties and customer benefits of the ZAF-2 towing hitch

Increased operating convenience

- Optimised hand clearance between the jockey wheel crank, handle and coupling handle due to the ergonomically angled handbrake lever
- Cushioned handbrake lever movement; the handbrake lever does not spring back
- Less force required to operate the handbrake lever
- Easier operation thanks to the ergonomically designed handle

Greater flexibility for the vehicle body

- Shorter overall length due to new spring-type actuator position
- Optimised travel for the handbrake lever
- Weight reduction of up to 18% depending on the model

Improved Serviceability

- Reduction in maintenance and repair times thanks to simple replacement of the pull rod bearing, shock absorber and tightening damper

Other advantages

- Integrated safety cable guidance
- Integrated ground support, protected brake lever box
- Optimised pull-away comfort by damper design and tightening element
- Automatic tracking of the handbrake lever
- Galvanised push rod
- Appealing design
- Optimised safety and comfort in conjunction with the WS3000 safety hitch



Optional

Cover for ZAF-2
with integrated plug holder 7 and 13-pin
BPW code no. 05.803.02.85.0
suitable for the following versions:
48.27.581.200
48.36.581.200

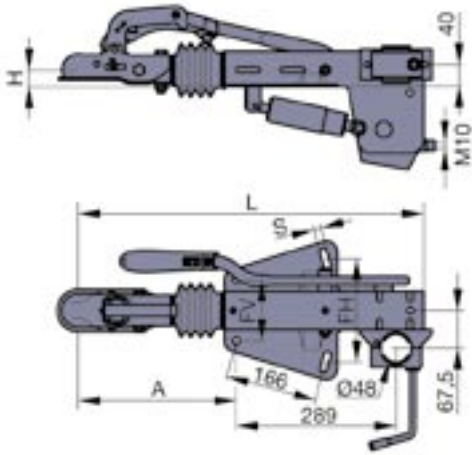

ZAF 1,0-2

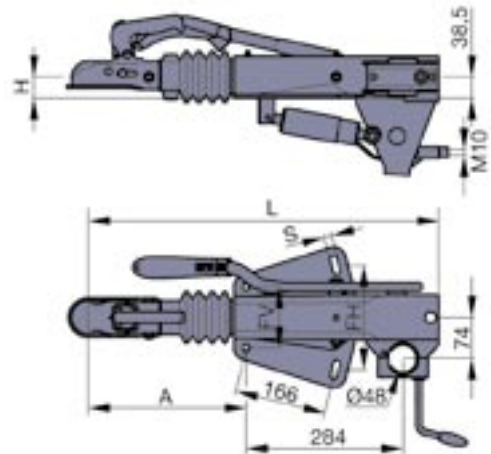

ZAF 1,5-2 / ZAF 2,0-2
Version C

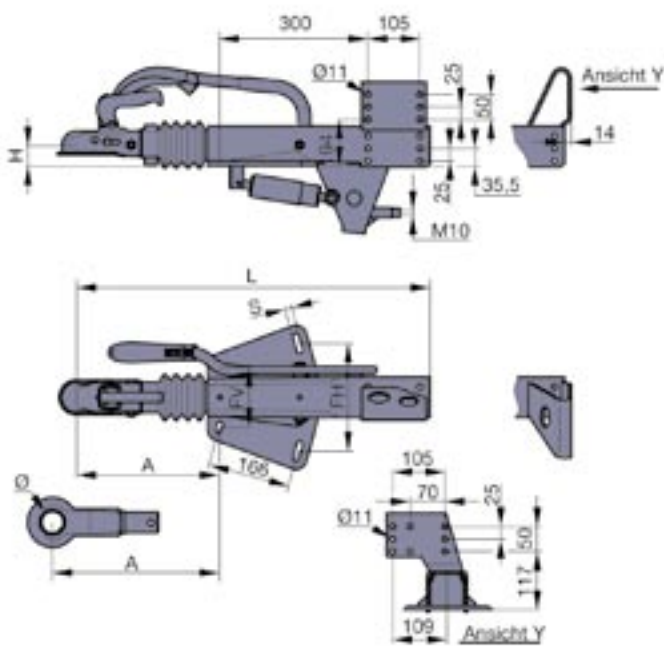

ZAF 1,5-2 / ZAF 2,0-2 / ZAF 2,8-2
Version G

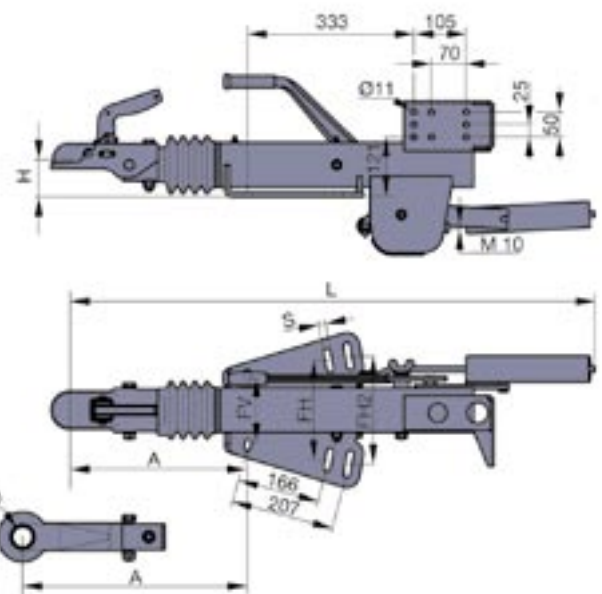

ZAF 3,5-1



Technical data

Gross vehicle weight rating (kg)	Sales designation	Order no. incl. ball hitch) ^{1,2,3,4}	Jockey wheel bracket * clamping bracket) ⁵	A	H	L	FH	FH 2	FV	S	Version	Permitted load (kg)	EC test symbol	Weight (kg)
560-1000	ZAF 1,0-2	48.20.581.200	Longitudinal*	286	30	625	162-211	-	100	13	C	75	e1*1491*94/20	12,7
750-1500	ZAF 1,5-2	48.27.581.200	Longitudinal*	286	39	635	167-217	-	110	13	C	100	e1*1437*94/20	14,5
		48.27.581.201	Longitudinal*	286	39	635	167-217	-	120	13	C	100	e1*1437*94/20	14,6
		48.27.581.202	Longitudinal	286	39	711	167-217	-	120	13	G	100	e1*1437*94/20	15,7
		48.27.581.203	Transverse	286	39	711	167-217	-	120	13	G	100	e1*1437*94/20	15,7
		48.27.583.200) ¹	Longitudinal	369	39	795	167-217	-	120	13	G	100	e1*1437*94/20	19,7
		48.27.586.200) ²	Longitudinal	369	39	795	167-217	-	120	13	G	100	e1*1437*94/20	19,8
		48.27.589.200) ³	Longitudinal	369	39	795	167-217	-	120	13	G	100	e1*1437*94/20	18,7
		48.27.589.201) ⁴	Longitudinal	369	39	795	167-217	-	120	13	G	100	e1*1437*94/20	20,8
1250-2000	ZAF 2,0-2	48.36.581.200	Longitudinal*	286	39	635	167-217	-	110	13	C	150	e1*1436*94/20	15,3
		48.36.581.201	Longitudinal*	286	41	635	167-217	-	120	13	C	150	e1*1436*94/20	15,4
		48.36.581.202	Longitudinal	286	41	711	167-217	-	120	13	G	150	e1*1436*94/20	17,1
		48.36.581.203	Transverse	286	41	711	167-217	-	120	13	G	150	e1*1436*94/20	17,1
		48.36.583.200) ¹	Longitudinal	375	41	795	167-217	-	120	13	G	150	e1*1436*94/20	21,1
		48.36.586.200) ²	Longitudinal	375	41	795	167-217	-	120	13	G	150	e1*1436*94/20	21,2
		48.36.589.200) ³	Longitudinal	375	41	795	167-217	-	120	13	G	150	e1*1436*94/20	20,1
		48.36.589.201) ⁴	Longitudinal	375	41	795	167-217	-	120	13	G	150	e1*1436*94/20	22,2
1800-2800	ZAF 2,8-2	48.44.581.200	Longitudinal	311	43	748	167-217	-	120	13	G	150	e1*1509*94/20	20,6
		48.44.581.201	Longitudinal	311	43	748	189-245	-	110-130	13	G	150	e1*1509*94/20	20,6
		48.44.581.202	Transverse	311	43	748	189-245	-	110-130	13	G	150	e1*1509*94/20	20,6
2500-3500	ZAF 3,5-1	48.51.581.006	Longitudinal	358	65	1044	166-233	175-258	130-150	14	G	150	e1*0976*94/20	29,5
		48.51.583.002) ¹	Longitudinal	450	65	1138	166-233	175-258	130-150	14	G	150	e1*0976*94/20	31,2
		48.51.536.001) ²	Longitudinal	345	65	1052	166-233	175-258	130-150	14	G	150	e1*0976*94/20	31,2
		48.51.589.001) ³	Longitudinal	365	65	1062	166-233	175-258	130-150	14	G	150	e1*0976*94/20	31,2

)¹ incl. DIN towing eye (d = 40)

)² incl. NATO towing eye (d = 76.0)

)³ incl. towing eye for Italy (d = 45)

)⁴ incl. towing eye for France (d = 68.0)

)⁵ incl. angle bolt (l = 110 mm)

C = Can be built under up to max. 60 mm drawbar strut height

G = Can be built under up to max. 120 mm drawbar strut height



Accessories

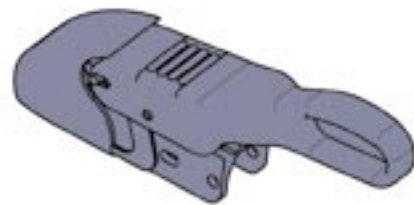

Plug holder for 7 and 13-pin plugs
05.189.30.46.0 - 7-pin pre-assembled
05.189.30.52.0 - 13-pin pre-assembled

WS 3000 safety hitch
02.1801.19.10

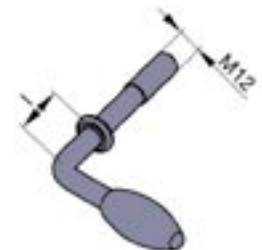
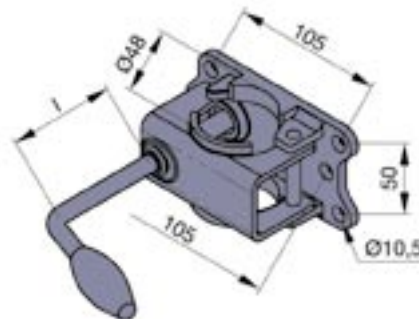
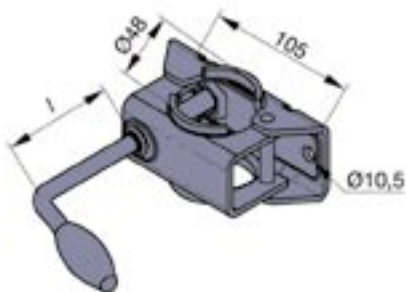

Clamping bracket
05.803.12.41.0 with bolt l = 35 mm
05.803.12.42.0 with bolt l = 110 mm

Clamping bracket
05.189.41.86.0 with bolt l = 35 mm

Angle bolt
03.341.20.03.0 l = 35 mm
02.1404.13.00 l = 110 mm

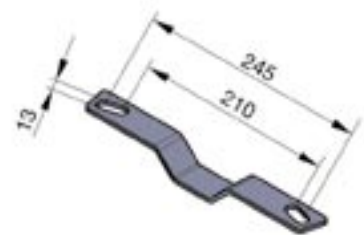

A-Frame Fixing Bracket (Front)
03.232.25.06.0

A-Frame Fixing Bracket (Rear)
03.293.01.68.0

A-Frame Fixing Bracket (Rear)
03.293.01.69.0



CORPORATE-ART BPW-Flyer-ZAF-2-05/1d

